



Marwood Close
Northampton,

oriordanbond
SALES & LETTINGS



GROUND FLOOR
584 sq.ft. (54.3 sq.m.) approx.

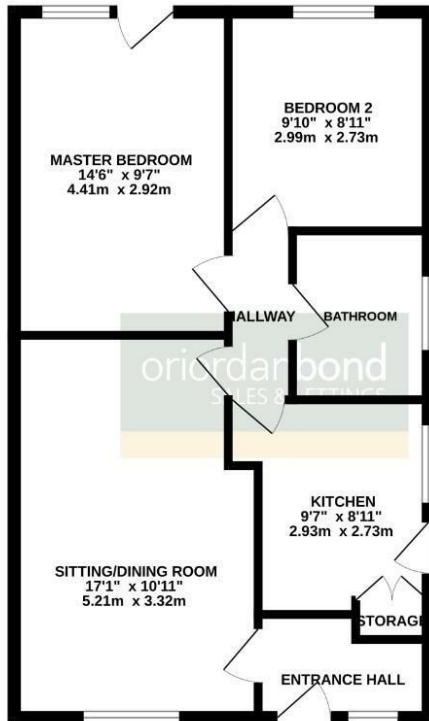

TOTAL FLOOR AREA : 584 sq.ft. (54.3 sq.m.) approx.
Whilst every attempt has been made to ensure the accuracy of the floorplan contained herein, measurements of doors, windows, rooms and any other items are approximate and no responsibility is taken for any error, omission or misstatement. This plan is for illustrative purposes only and should be used as such by any prospective purchaser. The services, systems and appliances shown have not been tested and no guarantee as to their operability or efficiency can be given.
Made with Hectagor ©2025

Marwood Close

Northampton
NN3 3NE

PRICE £284,995

A superbly presented semi-detached bungalow situated in this small, quiet cul-de-sac location within the very heart of Abington Vale. The property is just a short walk to Abington Park, several local amenities and good local schooling.

The accommodation comprises entrance porch, sitting/dining room, refitted kitchen, two double bedrooms and a refitted bathroom. Externally there is a well maintained enclosed rear garden to the rear. The front provides a large block paved driveway creating ample off road parking leading to a garage. Further benefits include gas radiator heating and uPVC double glazing. (A/600/M)

Additional information

- Council Tax Band: C
- Energy Efficiency Rating:

Viewing

Viewing strictly by appointment – details below

Disclaimer

O'Riordan Bond Estate Agents Limited has not tested apparatus, equipment, fittings or services and so cannot verify they are in working order. The buyer is advised to obtain verification from their solicitor or surveyor.

O'Riordan Bond Abington Vale Sales
01604 639007

abingtonvale@oriordanbond.co.uk

